

- Note:
- MAIN RING MUST BE IN OPERATION FIXED
 - 28pcs SCREW M5 St 12.9
 - TORQUE 8Nm
 - Unsealed space, see assembly manual in catalogue TS
 - RECOMENDATION: Sealing diameter on the sealing flange ($\varnothing 123 \begin{smallmatrix} -0.03 \\ -0.06 \end{smallmatrix}$)

UNSEALED FROM THIS SIDE

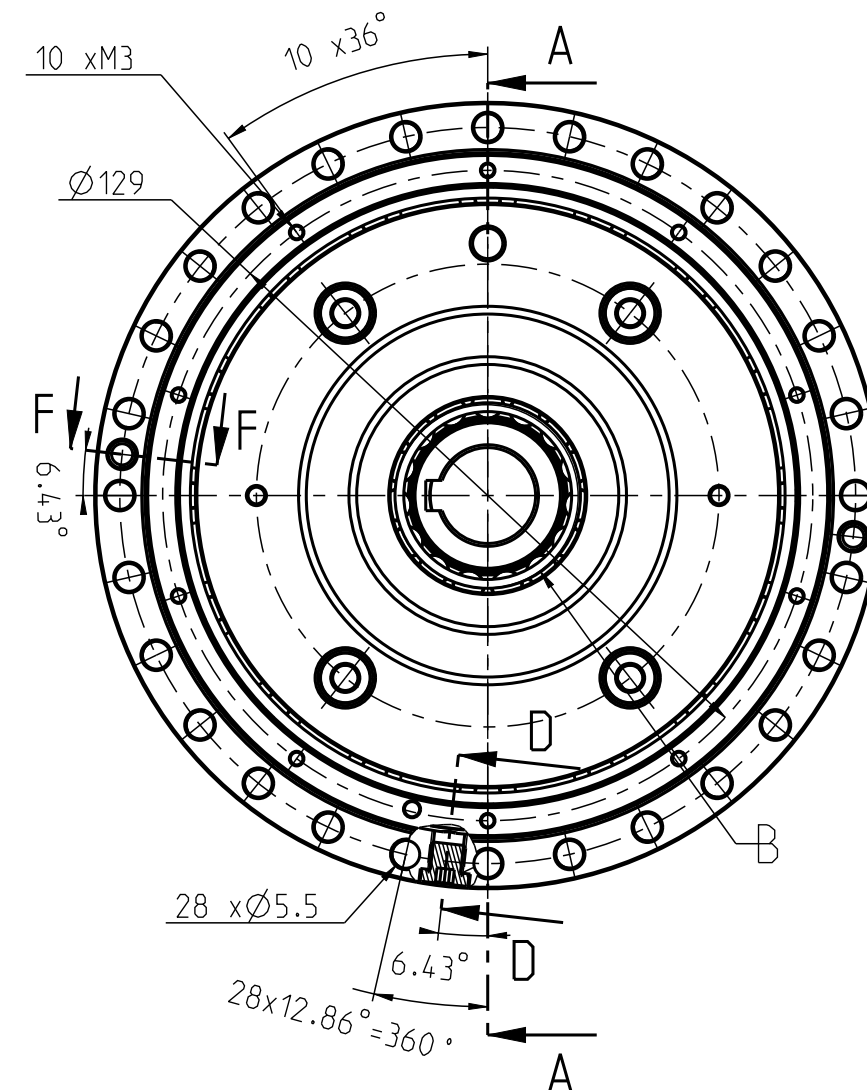
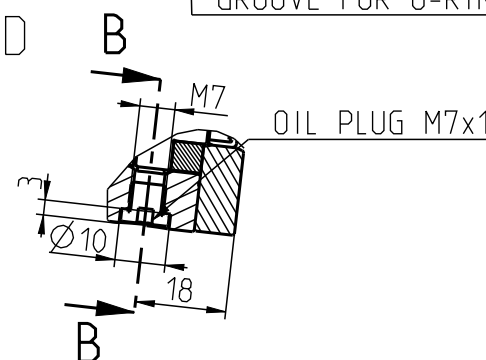
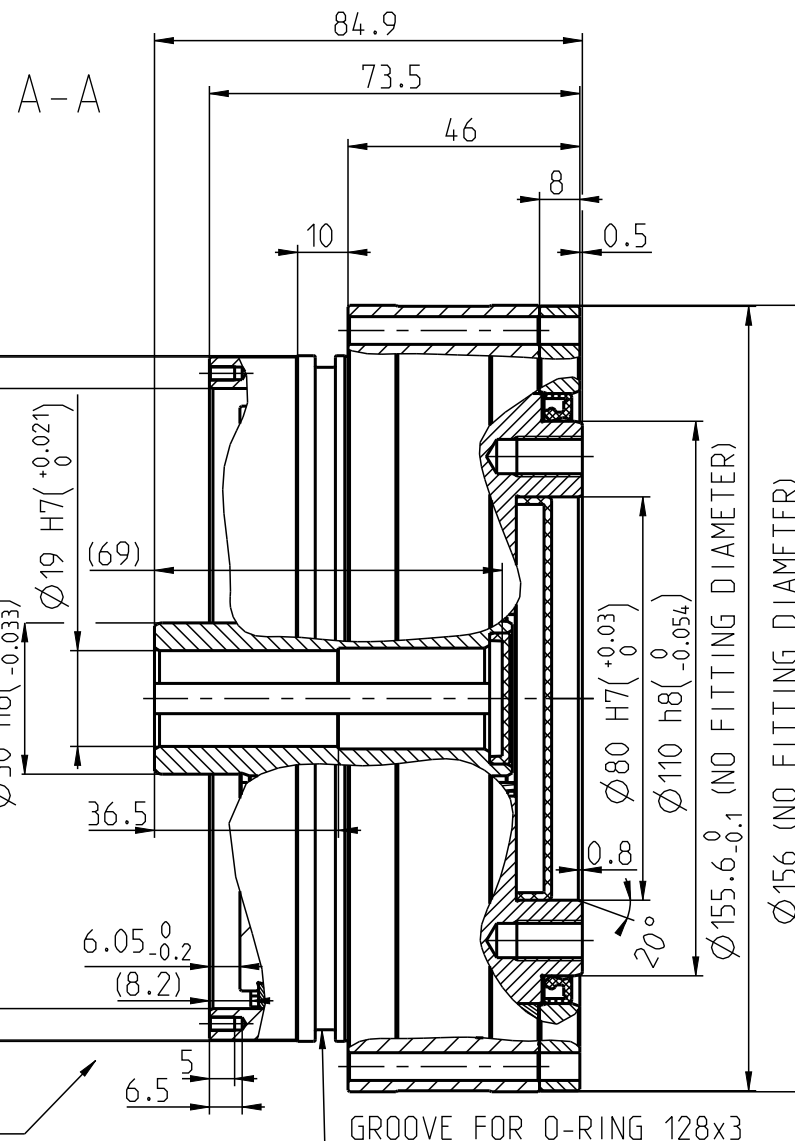

*	Hriadelova Zátka/ Shaft Plug	Zátka/ Plug	Note/ Poznamka
A	So zatkou/ With plug	So zatkou/ With plug	Standard
B	So zatkou/ With plug	Bez zátky/ Without plug	Na požiadanie/ On request
C	Bez zátky/ Without plug	So zatkou/ With plug	Na požiadanie/ On request
D	Bez zátky/ Without plug	Bez zátky/ Without plug	Na požiadanie/ On request

Vers/Revs	Change	Date	Signature
Material	-		
Semi-Product	-		Pieces -
Attachment		Techn.Prepared	
Design Prepared	Menyko	26-Feb-19	Techn.Checked
Design Checked	Klucar		Confirmed
Manuf.Checked		Valid From	B.Janek
TS 155-i-G-P19-0787*		155G	
Description		Type	

SPINEA
EXCELLENCE IN MOTION

Undimensioned Edges = 0.3x45°			
Intoleranced Dimensions - STN ISO 2768-mK			
Weight [kg]	7.430	Scale	1:1.5
		Position	-
Model Name/ Vers.	155_000G_P19_0787_P/	-	1
Drawing Name/Vers.	155_000G_P19_0787_P/		
Sheet/Sheets	1/1	ARTIKEL	-
0-787 P*0 #00-3			-/-
Drawing-No			Vers/Revs